

# Ezi-Crown<sup>®</sup>

UDMA-based light-curing composite resin for temporary restorations

## One-Step Provisional



- Easy
- Quick
- Clean
- Efficient

### Effortless & Esthetic

Ready-to-use, No odor, Sufficient working time,  
Three shades (A1, A2, A3)

### Quick & Stable

Simple and fast procedure combined with Any-Cem  
Implant. Proven provisional system provided by a  
trusted manufacturer

# Ezi-Crown®

## Fast and convenient fabrication, relining, and duplication of long-lasting and durable provisional restorations: Immediate implant crowns, Crowns, Bridges

Ezi-Crown allows fast and easy chairside fabrication of high-quality provisional restorations. No powder-liquid mixing needed — Just quick, esthetic results. Its non-sticky texture, pleasant scent, and heat-free curing ensure a comfortable experience with minimal dust during adjustments.

Save time and enhance your clinical workflow with Ezi-Crown!

### Indications

- Immediate implant crowns
- Crowns, bridges
- Relining of temporary restorations
- Duplication of old restorations

### Benefits

- Ready-to-use: Quick procedure and uniform quality
- Non-sticky: Easy handling
- No odor: Comfort for both practitioners and patients
- Heat-free: No pulp irritation or damage during polymerization
- Clean: Less dust compared to conventional materials
- Efficient polymerization: Light cure in 20 seconds
- Economical: No mixing tips required

### Step by Step Process

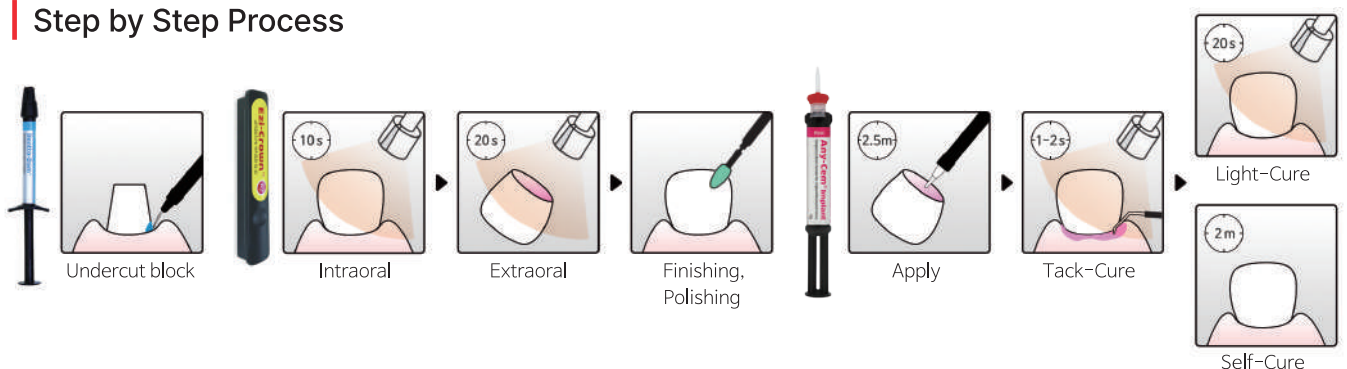

### Delivery Forms



Ezi-Crown® Refill 15g x 2ea

- #703-1 Ezi-Crown A1
- #703-2 Ezi-Crown A2
- #703-3 Ezi-Crown A3

### Video



## MEDICLUS

Headquarter | No.1210, 134, Gongdan-ro, Heungdeok-gu, Cheongju-si, Chungcheongbuk-do, 28576, Korea | +82 43 211 2877

Sales Office | No.206 Brown Stone, 464, Cheongpa-ro, Jung-gu, Seoul, 04510, Korea | +82 10 8385 2877

www.mediclus.co.kr | sales@mdclus.com

